

Please Note: Dimensions may vary by plus or minus 2% due to the rotational moulding process

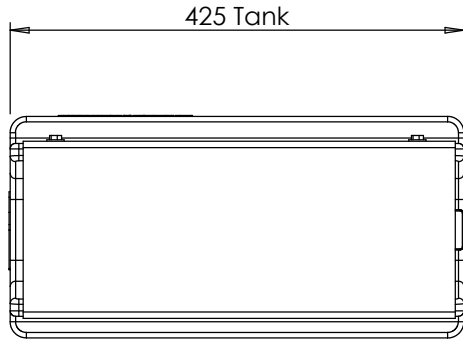

TOP VIEW

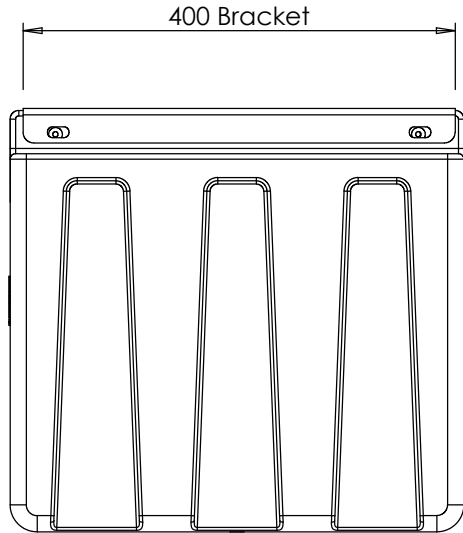

BACK VIEW

2mm Galvanised sheet
Mounting Bracket (supplied)

1" Tenob filler plug both ends (supplied)

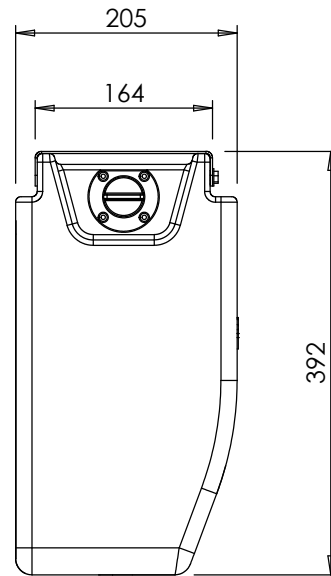

SIDE VIEW

4 x (M6x25) Stainless steel bolts (supplied)

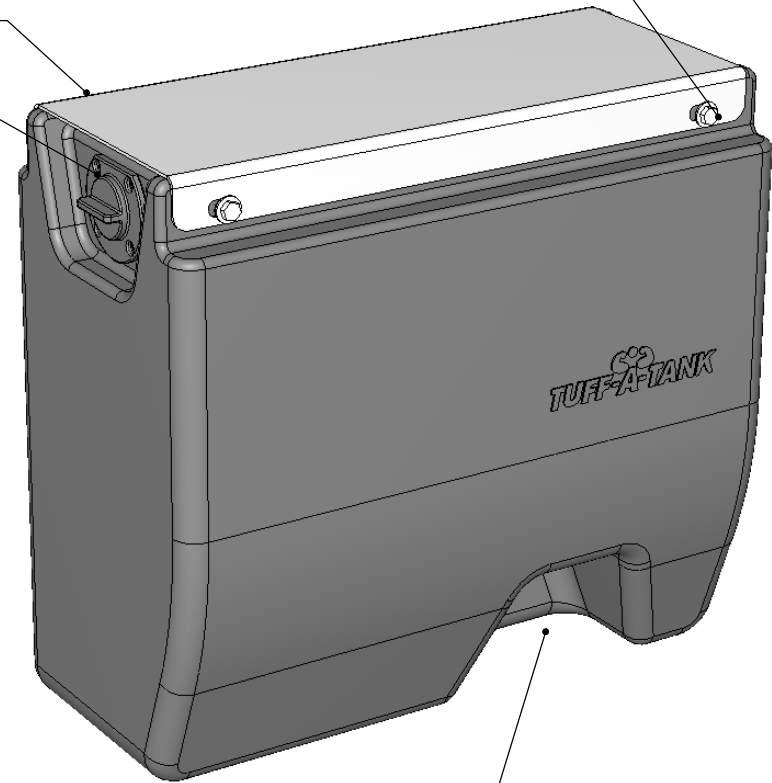

3/4" Black Poly Tap (supplied)

Material: Polyethylene

No.	DATE	BY	DESCRIPTION	GOUGH APPROV.
1			REVISION	
2				



Gough Industries Pty. Ltd.
833 Ingham Road
Bohle, Townsville
P.O. Box 7570, Garbutt BC, Qld. 4814.
Telephone 07 47747606
Facsimile 07 47747608
A.C.N. 010 028 547

This drawing remains the property of Gough Industries Pty. Ltd. It is subject to Gough Industries Pty. Ltd.'s recall and must not be reproduced in part or whole or it's contents divulged to third parties without prior written approval from Gough Industries Pty Limited.

DRAWN	Signature D.HOLLIER	Date 29.11.06
DRN. CHK		
ENGINEER		
ENG. CHK		
Eng. APPROVAL		
CONTROLLED DOCUMENT		NO

24 L Underbody Water Tank		
SCALE	A4	Gough Plastics Drg. No.
CAD FILE: S:\Products\Underbodies\24L Underbody Water Tank\Development\Solidworks Models\		REV